





### LEGENDA

-  FASCIA DI RISPETTO CIMITERIALE COME DA PGT VIGENTE
-  MODIFICA DELLA FASCIA DI RISPETTO CIMITERIALE
-  CONFINE ESISTENTE DEL CIMITERO
-  AREA CONSOLIDATA DEL CIMITERO
-  VIABILITA' ESISTENTE
-  VERDE ESTERNO DI RISPETTO
-  PARCHEGGI ATTREZZATI ESISTENTI
-  EDIFICI



Comune di  
**Gambolò**  
Provincia di Pavia

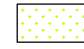
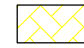
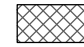
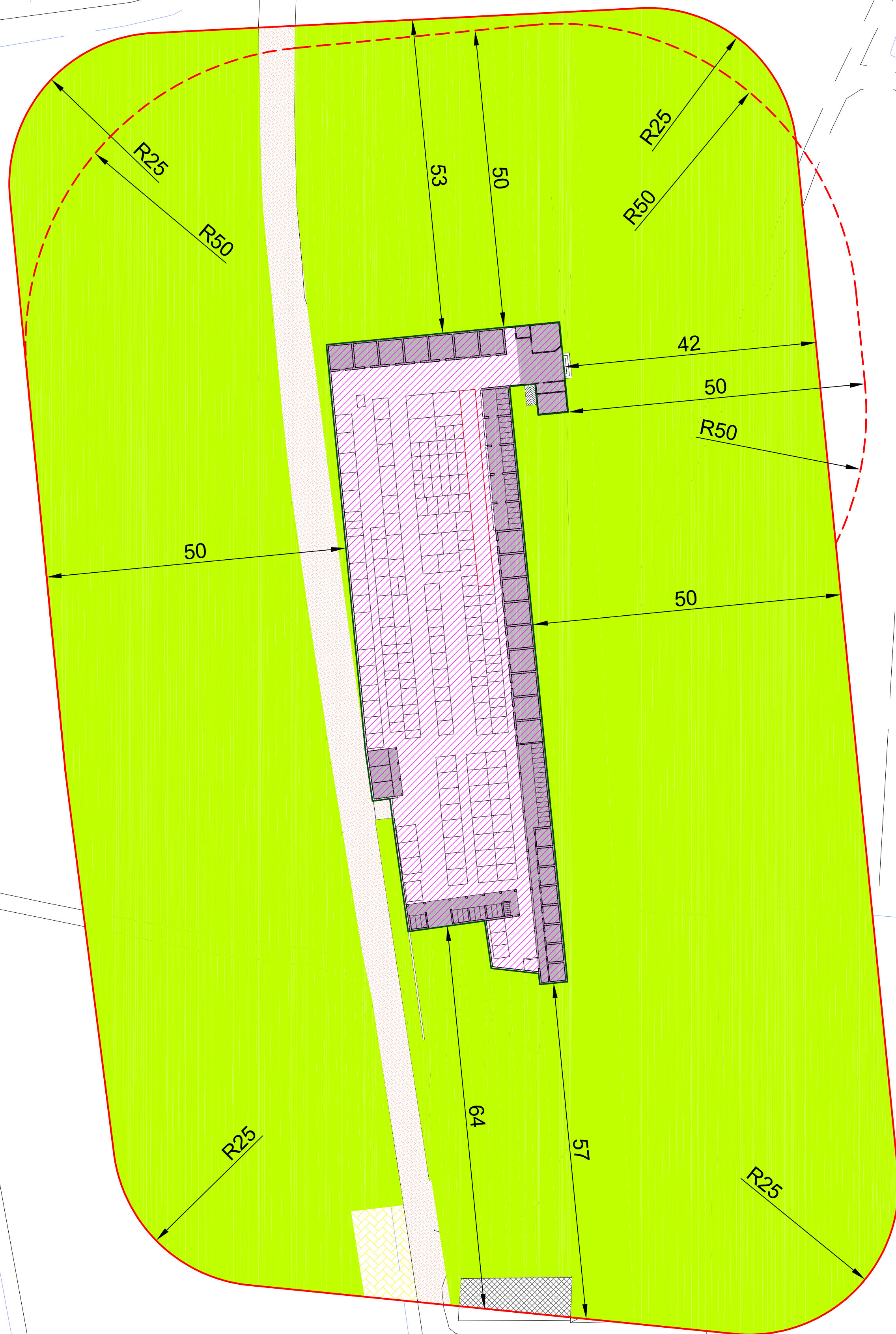

## Piano cimiteriale

### L.R.n°33/2009 art.75

tavola

**3.2**

1:500

**Inquadramento area esterna - Remondo**  
fascia cimiteriale esistente

rev. 00 - 06/11/2018

allegata alla delibera di approvazione C. C. n° del

il tecnico  
Arch. Primo Bionda

il responsabile del settore



VIGER srl Como (CO) via Morazzone 21, 22100 - tel. 031/564933 - fax. 031/72931144 - email: info@vigersrl.it